

PRODUCT CODE: CA108

PRODUCT DESCRIPTION: SELF DISCHARGING BOAT SKIPS

PRIMARY FUNCTION: FOR THE TRANSPORTATION OF WASTE MATERIAL

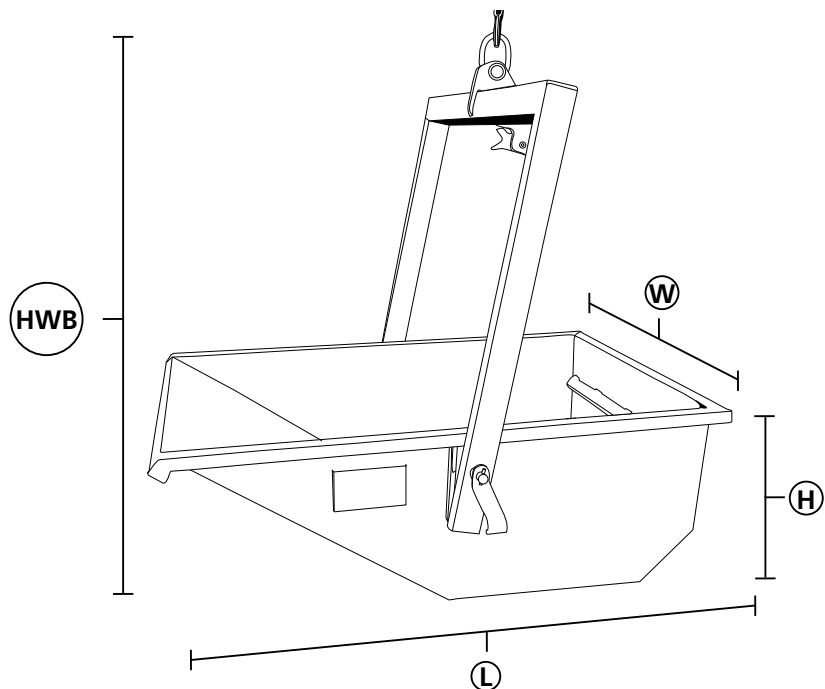

These skips are used for general muck and waste removal. The low loading height and drop down bale arm makes filling very easy. Designed with drop hanger, hook ring and latch for automatic emptying of the skip by the crane operator, without an assistant.

- Eliminates the need for a Banks man to enter the 'danger zone'.
- Will lift and tip part loads, a physical impossibility with traditional, manually operated, circular muck skips.

Cap. Ltrs	H mm	HWB mm	L mm	LWB mm	W mm	WLL. Kg	Weight. Kg
500	540	1350	1420	1590	1320	1000	130
750	650	1590	1660	1810	1380	1500	231
1000	650	1790	1970	2170	1620	2000	250
1500	910	1970	2200	1990	1620	3000	300
2000	910	2280	2240	2520	1810	4000	370

POWERED BY KNOWLEDGE

DISCOVER MORE, VISIT WWW.CQEGROUP.COM

BASIC SAFETY

IMPORTANT: Read these instructions before using this equipment. If there is anything you do not understand or if you have any concerns **DO NOT** use this equipment. Contact your supervisor or Conquip for advice.

You should check that you have considered all the safety requirements for the task you are doing and that this equipment is suitable.

You must protect bystanders and the general public by preventing access to the working area.

DO NOT use this equipment if you are tired, unwell or under the influence of alcohol or drugs. If you are taking any medicine or undergoing treatment you should inform your supervisor.

You must be competent, alert and medically fit when using this equipment. If you have a medical condition, a mental or physical disability, you must seek advice from a medical professional before using this equipment.

A **RISK ASSESSMENT** must be completed by a competent person before using this equipment to control risks, produce a safe system of work and ensure safety for you, your colleagues and others.

Your risk assessment will determine the correct Personal Protective Equipment (PPE) for the task you are doing. You **MUST** use it.

Conquip recommends that you should wear:

- Suitable Clothing
- Gloves
- Hard Hat
- Protective Footwear (steel toecaps)



DO NOT wear loose clothing or jewellery and tie back long hair to avoid becoming tangled or trapped in this equipment. You **MUST** make everyone in the work area aware of what you are doing. **NO SURPRISES.**

The equipment should be operated, stored and transported upright.

Make sure you know how to use this equipment and understand all aspects of its operation in case of emergency. This equipment weighs more than 25 kg. **DO NOT** lift or manhandle without machine assistance.

This equipment must be inspected by a competent person before use and then regularly, as determined by your risk assessment or working practice. If you have any concerns about condition or suitability **DO NOT USE.**

DO NOT operate this equipment near overhead power lines.

TAKE CARE in confined spaces, near ceilings or similar hazards. This equipment was designed for vertical lifting. **DO NOT** drag, tilt or swing.

Before lifting, check that the load is balanced and stable. Keep all personnel clear of raised loads and far enough away to allow for movement caused by a shifting load.

CRUSH RISK. Keep hands and feet clear of this equipment at all times to avoid injury.

DO NOT LEAVE UNATTENDED. The operator must remain in control of this equipment whenever it is loaded.

Before lowering a load make sure that the landing zone is clear

and capable of accepting the size and weight of the load.

Manoeuvre loaded or raised equipment carefully. Travel and turn slowly to avoid unit becoming unstable.

Please distribute the load in this equipment evenly.

DO NOT exceed the maximum working load limit shown on the serial plate.

Before lifting, forks must be fully engaged and the security chain or heel pins **MUST BE** correctly fitted.

HEAD, HANDS & FEET must be kept clear.

Trucks used for lifting and moving this equipment must be capable of lifting the equipment and its load.

DO NOT exceed **WORKING LOAD LIMIT.**

Before operating this equipment make sure that the working area is clear of hazards, obstructions and personnel.

Check that the equipment has the correct load rating and dimensions for the intended load.

Before operating this equipment, check that you have enough space for you to work safely. Allow space for the equipment to move if the load shifts.

PREPARATION

Make sure that the work area is clear of any obstructions.

Ensure adequate room around the unit for the operator to work safely.

THE CONTROLS

The self-discharging boat skip is fitted with a lock and release system. The lock is situated at the rear of the bin and engages with the catch fitted to the top of the lifting arm.

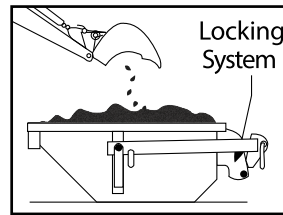

When the lifting arm is lowered fully, it will engage with the locking system. When next raised, the bin will rise and discharge its load.

When fully lowered a second time, the lifting arm will disengage from the locking system allowing the unit to be raised and manoeuvred to the loading bay.

If the lifting arm is out of sequence (locked when it should be unlocked) simply raise the lifting arm then lower to release the catch.

WARNING

NEVER raise and move the unit in the discharge position. Any sudden movement may cause the locking system to release giving a jolt to the crane and may also endanger/damage personnel and property.

SET UP

The lifting arm will be in the lowered position when attaching to the crane. Attach the lifting equipment's hook to the skips lifting arm lifting eye. Always ensure that the hook's gate is correctly closed and the lifting eye is seated correctly in the hook.

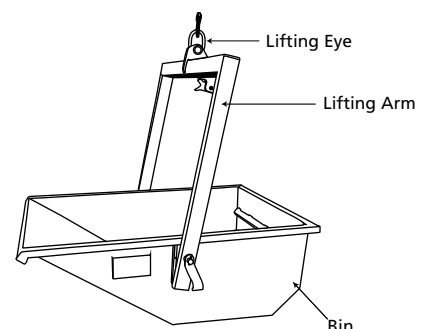

Raise the crane to bring the lifting arm upright and lift the unit just off the ground. Check that the skip is balanced correctly before lowering back to the ground. Land the skip on firm level ground, which is able to bear the unit's weight and load.

LOADING, MOVING & EMPTYING

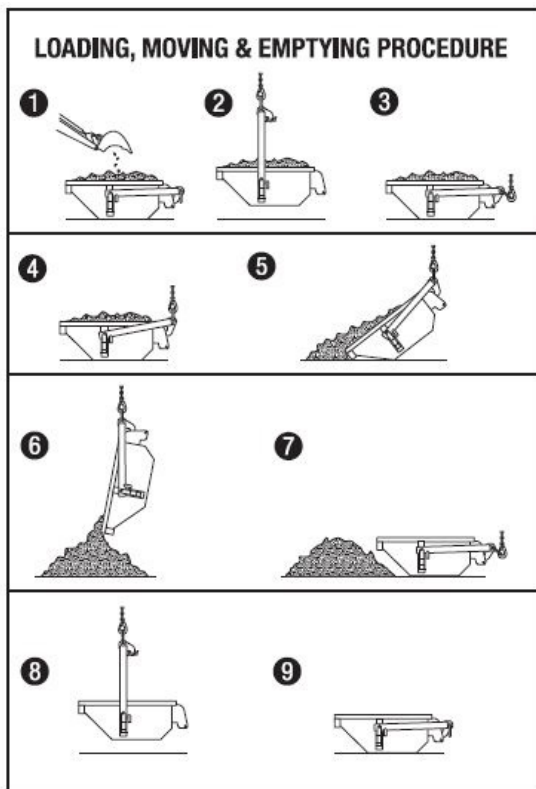

To ensure that both the Banksman and the Crane Driver are familiar with the correct and safe operation of the Boat Skip, it is advisable to have a practice run with the unit empty. This will ensure that both fully understand how the locking system functions.

Position the unit on firm level ground, which is able to bear the unit's weight and load.

Make sure that the lifting arm is in the lowered position and that is disconnected from the locking system (see 'CONTROLS').

1. You can now evenly fill the bin ensuring that the load is

no wider, longer or higher than the bins side walls. DO NOT overload by volume or by weight. The load should be evenly placed in the skip by weight and volume. Where necessary, cover the load with a safety net to safeguard against the load falling from the bin.

2. Once loaded and ready, clear all personnel from the area. Raise the skip just enough to allow sufficient clearance from the ground to check that the load is balanced. DO NOT enter the area nor allow anyone below the unit. You can now crane the skip to the discharge area. Move the skip slowly to prevent the skip from swinging. Lower the skip to the ground with the front of the bin facing the discharge area.
3. Lower the lifting arm fully to allow the locking system to engage.
4. Once ready, raise the crane to tip the bin and discharge the load.
5. Having emptied the bin, lower it back to the ground to allow the lifting arm to disengage from the locking system before once again raising the skip and moving to the loading area.

FINALLY

Once empty and lowered, disconnect the lifting equipment's hook from the skips lifting arm lifting eye.

All that remains is to give the unit a thorough clean before returning.

WARNING

If the lifting arm fails to lock or unlock, DO NOT attempt to rectify the problem yourself, contact Conquip Engineering Group for advice.

EQUIPMENT MAINTENANCE AND CLEANING

When not being used, store the unit in a clean condition and in a safe place where it will be protected from thieves and unauthorised users.

DO NOT use the boat skip for carrying toxic or dangerous materials or chemicals.

DO NOT light fires.

NOTE: FAILURE TO CLEAN THIS EQUIPMENT THOROUGHLY MAY RESULT IN A CHARGE.

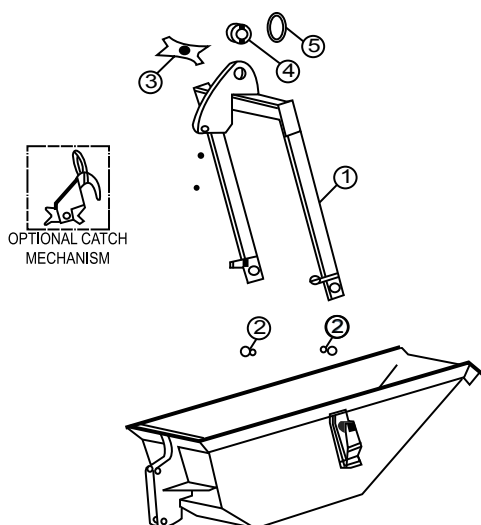

ITEM NO	PART NUMBER	DESCRIPTION
1	CA108/500-01	LIFTING ARM
2	CA108/500-02	PIVOT BOLT
3	CA108/500-03	CATCH ASSEMBLY
4	CA108/500-04	LIFTING EYE PIN ASSEMBLY
5	CA108/500-05	LIFTING EYE
6	CA108/500-06	OPTIONAL CATCH MECHANISM

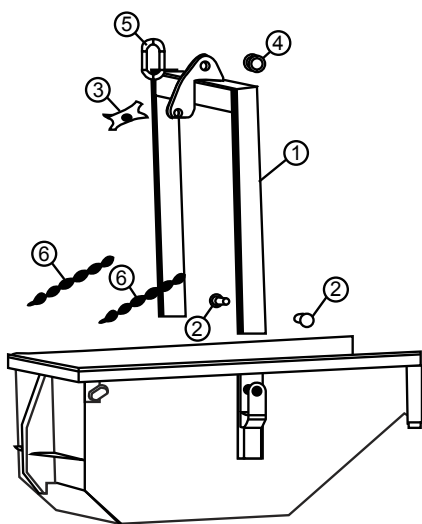

ITEM NO	PART NUMBER	DESCRIPTION
1	CA108/1500-01	LIFTING ARM
2	CA108/1500-02	PIVOT BOLT
3	CA108/1500-03	CATCH ASSEMBLY
4	CA108/1500-04	LIFTING EYE PIN ASSEMBLY
5	CA108/1500-05	LIFTING EYE
6	CA108/1500-06	LIFTING ARM RESTRAINT CHAIN

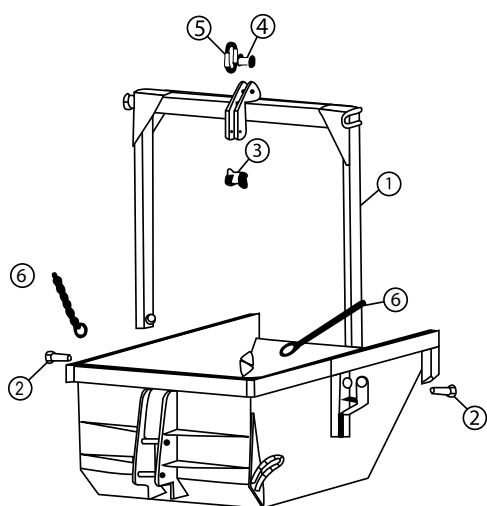

ITEM NO	PART NUMBER	DESCRIPTION
1	CA108/3000-01	LIFTING ARM
2	CA108/3000-02	PIVOT BOLT
3	CA108/3000-03	CATCH ASSEMBLY
4	CA108/3000-04	LIFTING EYE PIN ASSEMBLY
5	CA108/3000-05	LIFTING EYE
6	CA108/3000-06	LIFTING ARM RESTRAINT CHAIN



WARRANTY

Conquip Engineering Group products are covered by a 12 month warranty. Conquip Engineering Group undertakes to replace or repair, free of charge, any defect which the Company considers to be due to faulty workmanship or material within 12 months of the sale date, except for:

Defects arising from neglect, misuse or unauthorised modifications.

Damage caused by abuse, misuse, dropping or other similar damage caused by or as a result of failure to follow transportation, storage, loading, cleaning or operation instructions.

Alterations, additions or repairs carried out by persons other than Conquip Engineering Group or their recognised distributors.

Transportation or shipment costs to and from Conquip Engineering Group or their recognised agents, for repair or assessment against a warranty claim, on any product or component.

Materials and/or labour costs to renew, repair or replace components due to fair wear and tear.

Faults arising from the use of non-standard or additional parts, or any consequential damage or wear caused by the fitting or use of such parts.

Conquip Engineering Group and/or our recognised agents, directors, employees or insurers will not be held liable for consequential or other damages, losses or expenses in connection with, or by reason of, or the inability to use the product for any purpose.

MODIFICATIONS

If any third party work, modifications or alterations are to be carried out on the product which will involve any welding, drilling or any form of cutting or distortion of materials, full written approval must be obtained from Conquip Engineering Group prior to the work being carried out.

Conquip Engineering Group operate a policy of constant improvement and reserve the right to change specifications without notice.

© 2014 Conquip Engineering Group

TO ORDER CALL 0845 520 1101

CONQUIP
ENGINEERING GROUP

CONQUIP ENGINEERING GROUP | WATERBROOK ESTATE, ALTON, HANTS, GU34 2UD